

September 9, 2020

We started our outdoor visits last week. Thank you to everyone, residents and visitors alike, as we worked through some of the lessons learned. Below are guidelines for outdoor visits:

- **Outdoor visits** will only be allowed if scheduled in advance.
- Visits will be no longer than 30 minutes in length.
- If your loved one is not feeling well for any reason they will not be allowed to attend the outdoors visit. Additionally, we ask that any visitors who are not feeling well to please cancel their visit and reschedule for another time.
- No more than two visitors at any one time on the Haviland Hall deck or the gazebo area during the visit.
- If your loved one lives on Thomas Hall or Stabler Hall, call the front desk on Stabler Hall at 301-924-7531 to schedule a visit.
- If your loved one lives in Haviland Hall, call the nurse station on Haviland Hall at 301-924-7518.
- There will be no standing requests for a repeating, regularly scheduled outdoor visit.
- All scheduling for the visits will start on the Wednesday of the weekend to be scheduled.
  - You may begin calling at 9:00 am on Wednesday and you must call at least 24 hours before the day and time of your requested visit to allow time to schedule volunteers to assist with the visits.
- Initially, outdoor visits will occur Friday through Sunday, from 3:00 pm to 6:00 pm.
  - Inclement weather may change the outdoor visitation schedule.
  - If you have already scheduled a visit, we will contact you to adjust.
- Masks must be worn at all times during visits.
- No food or drink during these visits because that requires removing one's mask.
- NO PETS (Except guide dogs) will be allowed on the deck in Haviland Hall or in the gazebo area behind Stabler Hall. The volunteers will not be responsible for any pets.

- All gifts/packages that the visitor plans to give to the resident must be brought to the front door of Stabler Hall. The team at the front door will properly clean it and bring it to the resident for you. However there is no guarantee this will occur during your visit.
- Physical distancing of 6 feet is required which, unfortunately, means no hugging or holding hands.

The visits for Haviland Hall will be on the deck in the rear of the building. The visits for Stabler Hall and Thomas Hall will be in the gazebo in the rear of the building.

Please see map for parking for easiest access to these areas.

Friends House reserves the right to cancel or postpone the outdoor visits at any time for the safety of the residents. This may include air quality issues or precipitation.

**We understand Friday through Sunday 3-6 pm is very limited in time, however, as the process becomes more defined and more volunteers are secured to assist with the visits, the hours of operations may grow.**

Only one outdoor visit per location will be scheduled at a time. Visits will be no longer than a maximum of 30 minutes in length. This is in consideration of the residents' health, the volunteers' time, the added stretch on staff, and the goal of getting as many residents and family members as possible together to visit.

Any resident that is currently on the COVID-19 unit, observation unit, or admission isolation will not be allowed to participate in the outdoor visits until they transfer out from either of these units. However, window visits, Skype or FaceTime visits are still encouraged for anyone who cannot participate in outdoor visits.

Any violations of the policy, such as hugging, holding hands or getting closer than 6 feet or not wearing masks, could result in the resident being required to be on quarantine for 14 days and the visitors could be restricted from future outdoor visits.

We sincerely hope this is an improvement over the window visits or video calls, as it is our intent to serve our worthy residents as best we possibly can. Yet we understand it is still not the same as visiting in the room.

Thank you for your patience during this time as we do all we can to get back to some form of normalcy.

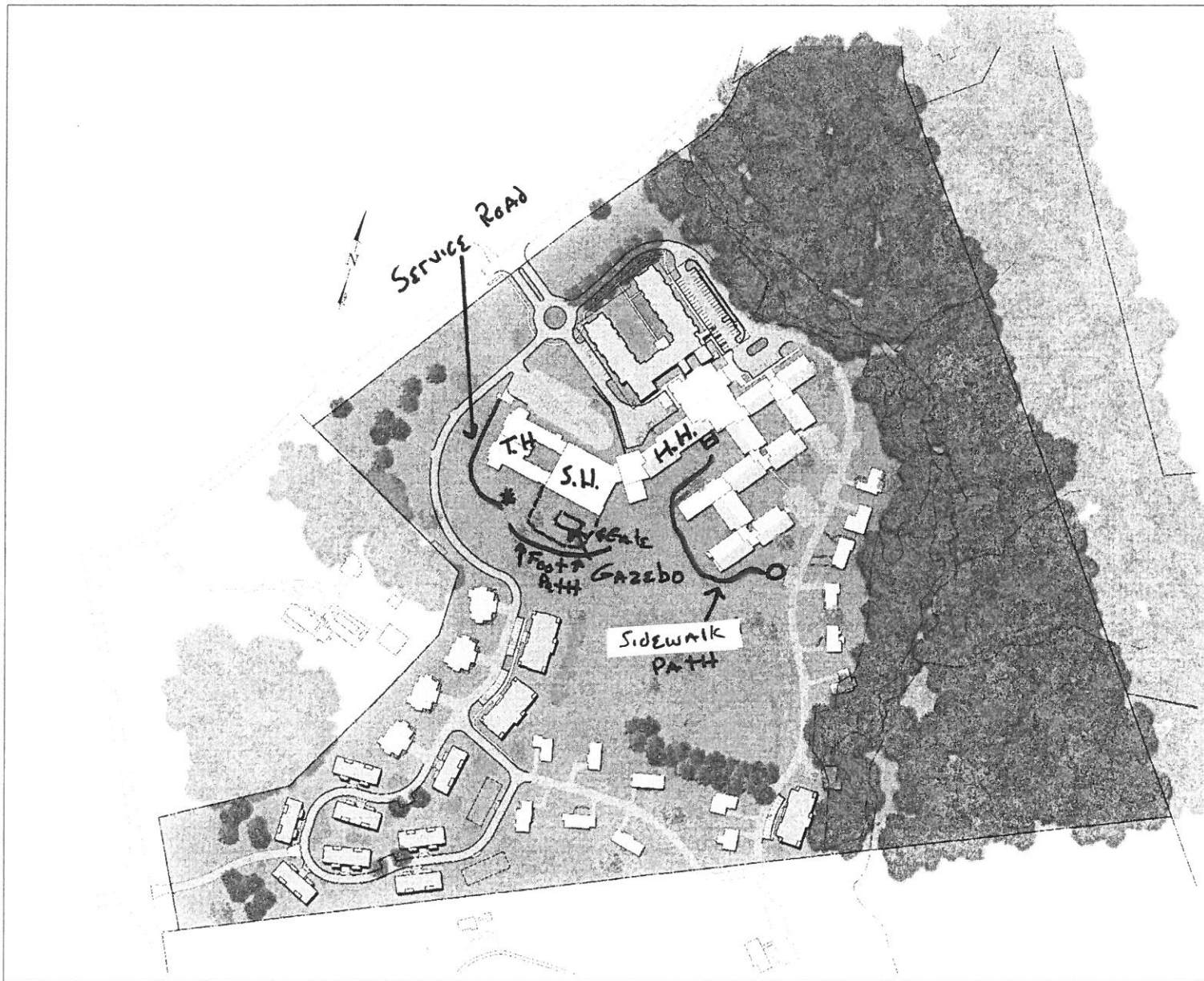

- \* - Park for Stabler Hall / Thomas Hall outdoor visits
- O - Park for Haviland Hall outdoor visits